

VOLUNTEER MEMO 2022

BROOKLINE HIGH SCHOOL

Compost Monitor Information

Arrival:

- Arrive at least 5-10mins before lunch begins
- Finding parking can be difficult so, please consider walking, biking, or taking public transport
- Enter through the main entrance of the STEM building (red arrow on map). Head to the main cafeteria
- No need to sign in at the main office
- Grab gloves + name tag, located on the round table under the main stairs of the STEM Building
- Look through all 10 bins (5 bins in main caf. 5 in common space)
 - Sort out any contamination from compost and recycling
 - When in doubt toss it out (in the trash bin)!

During Lunch:

- Station at least 1 volunteer in the main cafeteria and 1 in the STEM building common space (highlighted in yellow on the map)
- As students come up to dispose of their waste, educate them on proper separation methods
- Collect any uneaten non-perishable food for donation (i.e. fruits, apple sauce, cereal)
- Periodically check compost and recycling bins for contamination
- Help stack reusable trays

After Lunch:

- Check tables for any food waste or recyclable material left behind
- Do one final sweep of all 10 waste stations

Town of Brookline
Department of Public Works
870 Hammond Street
Chestnut Hill, MA, 02467
617-879-4900

Recycling and Composting Basics

Recycling:

- Clean, food residue-free plastic containers
 - Sandwich containers
 - No salad containers (Too much food residue)
- ✗ No milk or juice cartons (trash bin only)
- ✗ No straws, plastic utensils, or black plastic

Composting:

- Fruits + Vegetables
 - Remove produce stickers
 - Napkins and food-soiled paper
 - Compostable serviceware
 - Check to make sure it's BPI certified!
 - All food scraps (including eggs, meat & dairy)
 - ✗ No paper coffee cups (they are lined with plastic)
 - ✗ No liquids (add to liquid bucket)
 - ✗ No ketchup + dressing packets (trash bin only)
- *When in doubt toss it out (in the trash bin)*

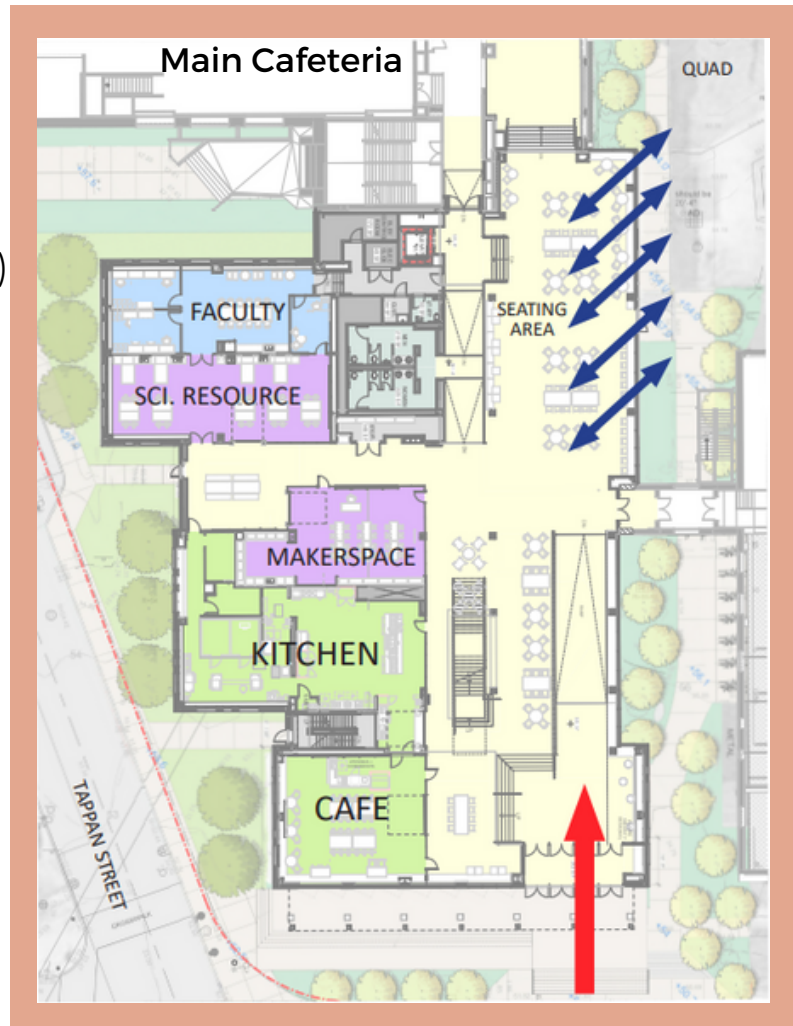

BHS Lunch Schedule

| Monday | Tuesday | Wednesday | Thursday | Friday |
|------------------------------|------------------------------|------------------------------|------------------------------|------------------------------|
| Lunch A 11:20 am-11:50 am | Lunch A 11:20 am-11:50 am | Lunch A 11:45 am-12:15 pm | Lunch A 11:20 am-11:50 am | Lunch A 11:20 am-11:50 am |
| Lunch B 12:24 pm- 1:00 pm | Lunch B 12:24 pm- 1:00 pm | Lunch B 12:45pm- 1:15 pm | Lunch B 12:24 pm- 1:00 pm | Lunch B 12:24 pm- 1:00 pm |

CONTACT INFORMATION
Chaimaa Medhat, Asst. Recycling Coordinator
 Cmedhat@brooklinema.gov
 Cell: 617-879-4914